

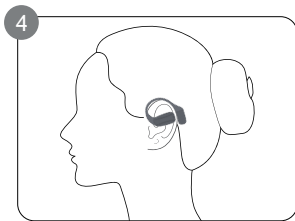

acer 譯秒聽

使用手冊
User Manual

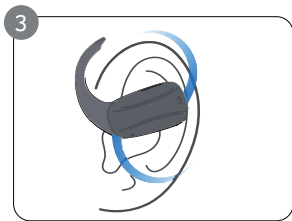

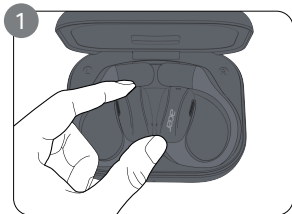

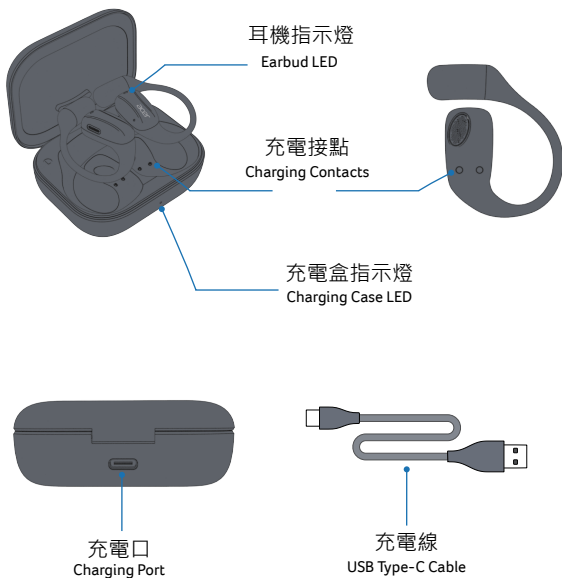

請使用隨附的 Type-C 充電線進行充電

Please use the included USB Type-C cable for charging

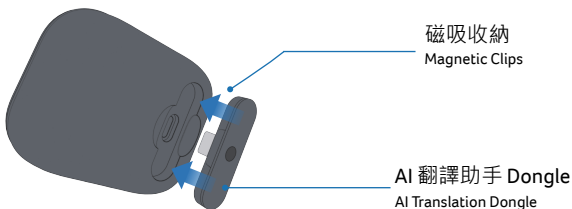

連接主機之 Type-C 口
Type-C Connector

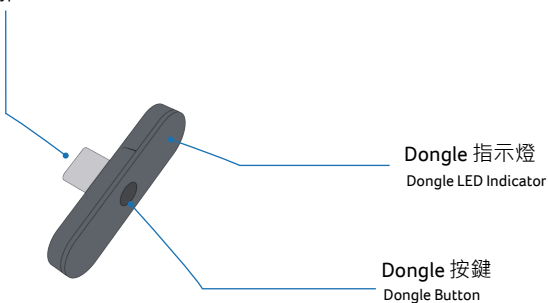

OHR578 Dongle

歡迎

感謝您選擇 acer 譯秒聽 AI 翻譯耳機acer AI TransBuds !

本產品採用舒適的耳掛式設計，結合先進的AI大模型技術，為您帶來便利且高效的跨語言溝通體驗。請仔細閱讀本手冊，以便充分發揮產品性能。

包裝清單

AI翻譯助手Dongle×1(以下簡稱Dongle)

耳機(左右耳各×1)

充電盒×1

Type-C充電線×1

說明書×1

相容主機

Android : 搭載Android 10或以上系統之手機或平板

iOS : iPhone 15或以上手機或配備Type-C接口的iPad

macOS : 搭載Apple M系列晶片之Mac電腦

Windows : 搭載Win 10或以上系統之64位元x86電腦

充電說明

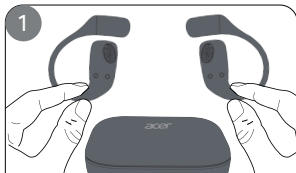

請從包裝中取出耳機與充電盒

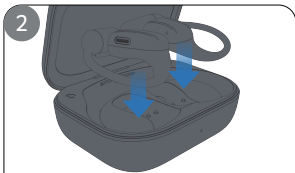

將耳機放入充電盒中，耳機指示燈將會亮起

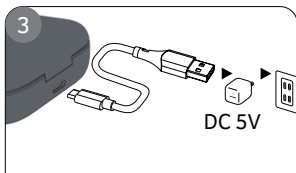

請連接符合當地安規的DC 5V充電口供電

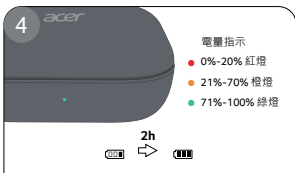

充電盒充電過程中指示燈持續閃爍



充電盒溫度超過45°C自動切斷充電和對外供電

操作方法

acer 譯秒聽 AI 翻譯耳機提供兩種連結方式對應不同場景需求：

「一般模式」：無需AI服務時，耳機直接無線連接手機或電腦。

「AI模式」：Dongle 從USB口插入手機或電腦，耳機將自動連接至 Dongle。連接成功後配合譯秒聽App方可使用以下AI服務：

通話翻譯 | 會議記錄 | 影音翻譯 | 現場聽譯 | 面對面翻譯 | AI總結

功能	操作方法
開機	取出充電盒自動開機 / 手動長按四秒開機
關機	放回充電盒自動關機 / 手動長按四秒關機
耳機TWS 配對	自動配對
切入AI模式	Dongle插入手機或電腦後會自動連接耳機 再開啟譯秒聽App後即進入AI模式
切入一般模式	拔出Dongle後自動切換回一般模式
切換空間音效	一般模式下左耳或右耳四擊
喚起手機語音助手	一般模式下左耳或右耳三擊
上一曲	一般模式下左耳長按二秒
下一曲	一般模式下右耳長按二秒
播放 / 暫停	一般模式下左耳或右耳雙擊
拒聽來電	一般模式下左耳或右耳長按二秒
接聽	一般模式下左耳或右耳雙擊
掛斷	一般模式下左耳或右耳雙擊

譯秒聽 App

通話翻譯：即時雙向通話翻譯，輕鬆實現遠端跨語言溝通。





會議記錄：即時生成逐字稿，支援線上與線下會議。

影音翻譯：為視訊與音訊內容提供即時翻譯，打破語言障礙。

現場聽譯：適用於現場活動、講座等場合，進行即時翻譯。

面對面翻譯：面對面對話時，提供即時翻譯和語音轉文字服務。

AI總結：線上線下會議內容，錄音 + 文字稿，大模型智慧摘要。

下載App	 搜尋「譯秒聽」  GET IT ON Google Play  Download on the App Store
軟體使用說明	 Android  iOS  Windows  macOS
授予權限	首次開啟「譯秒聽」App，請按照提示授予App所需的權限，以確保正常運作。
連接Dongle 與耳機	手機插入Dongle並連接耳機後，若遇彈出式視窗索取授權或要求開啟藍牙，請點選同意。 Android系統中，「譯秒聽」應用程式將自動啟動；其它系統中需手動啟動「譯秒聽」App，以獲得全部AI翻譯服務。

AI模式：需 Dongle 和 譯秒聽 App

Dongle為智慧型轉接器，負責與耳機之間的即時翻譯訊號傳輸，必須連接並配合官方App使用才能啟動完整的AI翻譯功能。

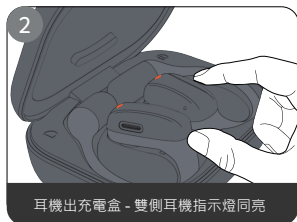
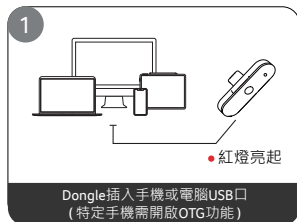

AI 模式 - 指示燈

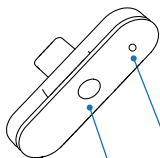

紅燈常亮：Dongle供電中

藍燈閃爍紫光：已成功與耳機配對，App未開啟

藍燈常亮：已成功與耳機配對並連接至App

手動連接按鈕

短按一秒鐘：耳機未自動連線時，手動重置連接耳機



若指示燈異常，請重新插拔Dongle

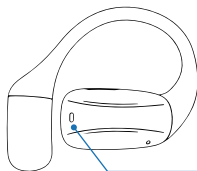

開機：白燈亮一秒後熄滅

充電中：橙燈恆亮

單耳搜尋連接：橙白燈交替閃

雙耳搜尋連接：主耳機橙白燈交替閃，副耳機不閃燈

成功連接：耳機指示燈由閃爍變為熄滅

一般模式

日常使用 - 享受高品質的雙聲道立體聲效能，適合聽音樂、看電影等

日常娛樂，也可用於無需AI輔助通話、會議。

空間音效 - 提供沉浸式空間音效，增強影音體驗，提升聽覺效果。

(一般模式下左耳或右耳四擊開啟空間音效)

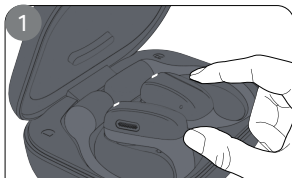

耳機出充電盒 - 雙側耳機指示燈同亮

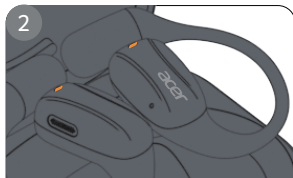

搜尋配對 - 單側耳機指示燈閃爍

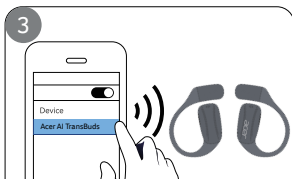

手機或電腦直接無線連接耳機



連線成功 - 耳機指示燈熄滅

一般模式 - 觸碰按鍵功能

左耳或右耳四擊：開關空間音效
左耳或右耳三擊：開啟語音助手
(僅限部分手機)

左耳或右耳雙擊：接聽 / 掛斷
左耳或右耳長按二秒：拒絕接聽
左耳或右耳雙擊：播放 / 暫停
左耳長按二秒：上一曲
右耳長按二秒：下一曲
手動開/關機：長按四秒

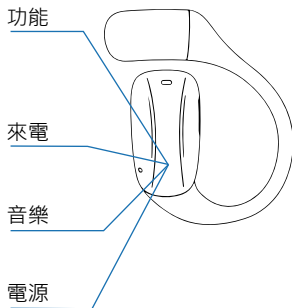

插入Dongle使用AI翻譯模式時，耳機不支援上述功能

基本參數

品名	acer 譯秒聽 AI 翻譯耳機	配對名稱	Acer AI TransBuds
型號	OHR578	協議版本	V5.4
材質	ABS	充電接口	USB Type-C
Part No.	GP.HDS11.02U	充電電壓	DC 5V±5%
Dongle 型號	OHR578 Dongle	整機重量	65.1g
充電盒尺寸	74.9×59.5×29.2mm	耳機重量	6.8g×2
充滿電時間	< 2小時	包裝尺寸	143×110×45mm
通話續航時間	約5小時	耳機尺寸	16.5×37.7×42.5mm
音樂續航時間	約6小時	喇叭尺寸	11×15mm
耳機電池容量	50 mAh	喇叭規格	24 Ω
充電盒電池容量	400 mAh	頻響範圍	20Hz - 20kHz

- 取得審驗證明之低功率射頻器材，非經核准公司、商號或使用者均不得擅自變更頻率、加大功率或變更原設計之特性及功能。
- 低功率射頻器材之使用不得影響飛航安全及干擾合法通信；經發現有干擾現象時，應立即停用，並改善至無干擾時方得繼續使用。
- 前述合法通信，指依電信管理法規定作業之無線電通信。
- 低功率射頻器材會受警用通信或工業、科學及醫療用電波輻射性電機設備之干擾。

安全注意事項

- 請勿將耳機放在潮濕、充滿灰塵、油煙或陽光直射的地方。
- 請勿將耳機長時間留在車內。否則可能會造成故障。
- 使用本耳機以高音量收聽可能會影響您的聽力。
- 請勿在本耳機上方重物或施加壓力，否則可能會導致耳機在長期存放中發生變形，請勿使本耳機受到過度撞擊。
- 請使用柔軟的乾布清潔耳機。
- 請勿將耳機放入水中浸泡。
- 如果在使用藍牙耳機設備後感到不適，請立即停止使用藍牙耳機設備。如果問題仍然存在請聯絡本地的經銷商。
- 請勿使電池長時間暴露於陽光或火等熱源。
- 鋰電池用戶不可自行更換，如電池損壞，請聯繫售後人員。
- 不得對各種合法的無線電業務產生有害干擾，一旦發現有干擾現象時，應立即停止使用，並採取措施消除干擾。
- 請勿在危險場所使用，除非能夠聽見周圍的聲音。
- 本機及其小部件有被誤吞的危險，使用後，請將本機放在充電盒內，然後存放在兒童無法接觸到的地方。

如何獲得保固服務

請訪問<https://www.acergadget.com/customer-support/>，並以網站公告之最新資訊為準。*服務內容異動，恕不另行通知

客服專線：(02)2790-4680

客服信箱：service@acergadget.com

服務時間：週一至週五 08:30-17:00 (例假日除外)

保固條款

- 本產品 (耳機一對、充電盒、Dongle) 保固期為12 個月。
- 自銷售日起12個月內，在正常使用下發生故障，倚天酷暑售後服務將提供免費檢測換貨。
- 若超過保固期12個月，亦可進行檢測換貨，屬於有償保固，價格依照零件不同而有不同報價。
- 本產品無國際保固，保固適用地區僅限台灣。
- 維修時，請提供購買發票或保固卡，若無法提供，則保固期限將從產品生產月份起算。
- 若原機種零件缺貨或停產，本公司將依折舊價提供等值產品更換，或經同意後升級並酌收價差。
- 所有退還給倚天酷暑售後服務換貨的產品，必須使用原廠包裝。
- 若您對產品的包裝不當，倚天酷暑售後服務將拒絕接受任何不符合標準之換貨。

保固條款

- 天災、蟲害、寵物、電擊等外力損壞。
- 外部設備影響導致的故障。
- 未依手冊操作、安裝第三方應用程式或修改系統。
- 受潮、破損、變形或非授權維修與零件更換。
- 運輸、存放不當導致的故障。
- 使用不符合產品規格的配件導致異常。

Welcome

Thank you for choosing acer AI TransBuds.

This product is designed with an ergonomic fit and integrated AI translation features. Please read this manual carefully before use to ensure the best performance and user experience.

Package Contents

AI Translation Dongle×1 (Hereinafter referred to as Dongle)
Earbuds (Left and Right)×1
Charging Case×1
Type-C Charging Cable×1
User Manual×1

Compatible Devices

Android: Smartphones and tablets running Android 10 or later
iOS: iPhone 15 or later, and iPad models with Type-C connector
macOS: Apple Mac computers with M-series chips
Windows: Windows 10 or later, 64-bit x86 computers

Charging Instructions

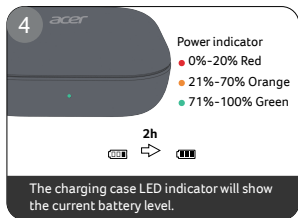
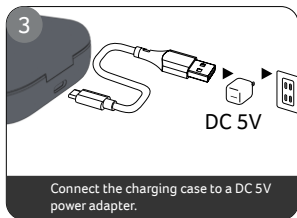
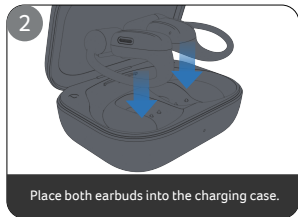
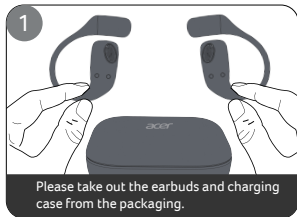

To protect the battery from overheating, charging will automatically stop if the charging case temperature exceeds 45°C.

How to Use

Your earbuds features two modes.

Normal Mode: For general use, connects directly to your phone/computer **without** AI services.

AI Mode: Needs to be used along with AI TransGo App(Hearinafter referred to as App) for following AI services:

Call Translation | Meeting Transcription | Media Translation
Live Transcription | Face-to-Face Translation | AI Summary

Function	How to use
Power On	Take out from case (Auto) / Press & hold (4s)
Power Off	Return to case (Auto) / Press & hold (4s)
Pairing the earbuds (L/R)	No action needed, the two earbuds pair automatically.
AI Mode	Plug in the Dongle (to phone/computer). Earbuds will connect automatically. Open the App to use.
Normal Mode	Connection mode will switch automatically when unplugging the Dongle.



More touch control functions are described on page 21.

AI TransGo App

Call Translation: Real-time, two-way translation for phone calls.



Meeting Transcription: Real-time transcription for meetings.

Media Translation: Instantly translates videos and media.

Live Transcription: On-the-spot transcription for live events and lectures.

Face-to-Face Translation: Instant translation and transcription for in-person conversations.*Face-to-Face mode only available on Android and iOS.

AI Summary: Records, transcribes, and creates smart summaries of your meetings.

App Installation	 <div>Search AI TransGo</div> <div> GET IT ON Google Play</div> <div> Download on the App Store</div>
Granting Permissions	After plugging-in, please allow Bluetooth access for the Dongle to connect to the earbuds.
Connecting Dongle & Earbuds	<p>For Android and iOS versions, you will have to grant permission to Bluetooth access after plugging in the Dongle and connected to the earbuds.</p> <p>Also, for Android version, the App will open automatically after plugging in the Dongle. As for other systems, you will need to manually open the App to use AI features.</p>

AI Mode : Requires Dongle & App

The Dongle transmits real-time translation App to the earbuds. It must be used with the to enable the full AI features.

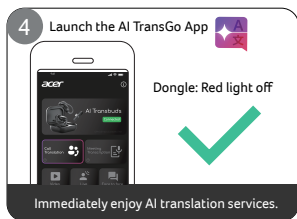
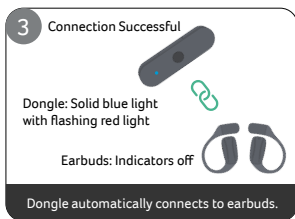
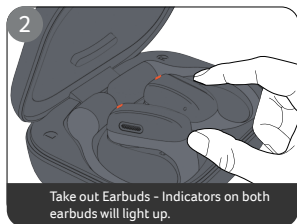
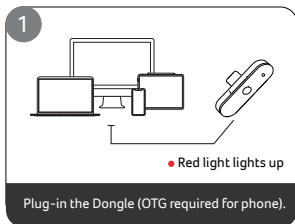

AI Mode - LED Indicators

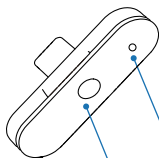

Red light (steady): Dongle is powered.
Flashing Blue/Purple: Dongle paired with earbuds
(App closed).
Blue light (steady): Connected to App.

Manual Connection Button

Short press (1 sec): Manually reset connection
(if automatic connection fails).



If indicator behaves abnormally, please unplug and plug in the Dongle again.

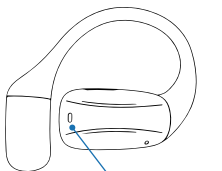

Power on: White light will turn on for 1 second.

Charging: Steady orange light.

Single-ear pairing: Orange and white light.

Dual-ear pairing: Main earbud flashes orange/white; indicator for secondary earbud stays off.

Connected: Earbuds indicator turns off.

Normal Mode

Daily Use

Enjoy high-quality stereo sound, perfect for daily entertainment like music and movies. Also suitable for calls and meetings without AI assistance.

Spatial Audio

Delivers an immersive spatial audio experience, enhancing movies and games for a more captivating sound.

1

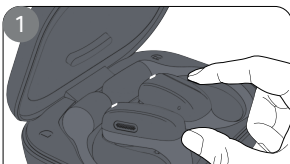

Take the earbuds out of the case. The indicator lights on both earbuds will turn on.

2



The earbuds will enter pairing mode, and the indicator light on one earbud will start flashing.

3

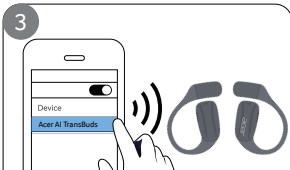

Connect to "Acer AI TransBuds" directly from your phone or computer's Bluetooth settings.

4



Connection successful - Earbud indicator light turns off.

Normal Mode - Touch Control

Quadruple tap (L/R): Toggle Spatial Audio.

Triple tap (L/R): Activate voice assistant
(Supported devices only).

Double tap (L/R): Answer / End call.

Press & hold 2s (L/R): Reject call.

Double tap (L/R): Play / Pause.

Press & hold 2s (Left): Previous track.

Press & hold 2s (Right): Next track.

Manual Power On/Off: Press & hold 4s.

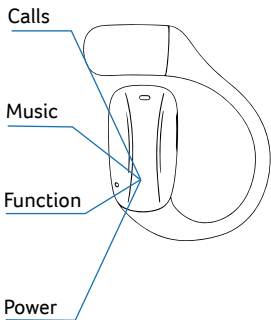

The above functions are not available in AI Mode.

Specifications

Product Name	Acer AI TransBuds	Pairing Name	Acer AI TransBuds
Model	OHR578	Version	V5.4
Material	ABS	Charging Port	USB Type-C
Part Number	GP.HDS11.02U	Power Input	DC 5V \pm 5%
Dongle Model	OHR578 Dongle	Total Weight	65.1 g
Charging Case Dimensions	74.9×59.5×29.2 mm	Earbud Weight	6.8 g × 2
		Packing size	143×110×45 mm
Charging Time	< 2 hours	Earbud Dimensions	16.5×37.7×42.5 mm
Talk Time	Approx. 5 hours		
Music Playback Time	Approx. 6 hours	Driver Size	11×15 mm
		Impedance	24 Ω
Earbud Battery Capacity	50 mAh	Frequency Response	20Hz - 20kHz
Charging Case Battery Capacity		400 mAh	

Users, companies, and/or distributors shall not modify frequency, increase power output, and/or change original design or functions of certified low-power RF device.

Low-power RF equipments must not interfere with aircraft safety and/or legal communications*. If interference occurs, users must stop using the equipment immediately until the interference is resolved.

*Legal communications refers to radio communications operated under telecommunication regulations.

This device may experience interference from industrial, scientific, or medical RF equipments or police communication systems.

Safety Information

- Do not place the earbuds in humid, dusty, oily, or sunlit environments.
- Avoid leaving the earbuds in a car for extended periods.
- Listening at high volume may damage your hearing.
- Do not apply pressure or heavy weight on the earbuds; prolonged deformation may occur.
- Use a soft dry cloth for cleaning.
- Do not immerse in water.
- Stop using immediately if discomfort occurs; contact your local distributor if the issue persists.
- Do not expose the battery to sunlight, fire, or excessive heat.
- Lithium batteries are non-replaceable by users. Contact service personnel if damaged.
- Operation must not cause harmful interference to licensed wireless services.
- Stop using immediately if interference occurs.
- Do not use in dangerous environments unless ambient sounds can be clearly heard.
- Small parts may pose a choking hazard. Store the product in its charging case and keep out of reach of children.

Warranty Service

Visit: <https://www.acergadget.com/customer-support/>

Please refer to the latest information on the website (subject to change without notice).

- Customer Service Hotline: (02) 2790-4680
- Email: service@acergadget.com
- Service Hours: Mon–Fri, 08:30–17:00 (excluding holidays)

Exclusions from Warranty

- Damage caused by natural disasters, insects, pets, or electrical shock.
- Faults caused by external devices or improper installation.
- Damage due to misuse, third-party software, or system modification.
- Moisture, deformation, breakage, or unauthorized repair/replacement.
- Improper transport or storage.
- Use of non-compliant accessories leading to malfunction.

Warranty Terms

- The product (earbuds, charging case, Dongle) is covered by a 12-month warranty from the date of purchase.
- Within warranty period under normal use, free inspection or replacement will be provided.
- After warranty period, paid maintenance service is available; charges vary by component.
- Warranty applies only within Taiwan and does not cover international service.
- Please provide proof of purchase or warranty card for service; otherwise, warranty period is counted from the manufacturing date.
- If original parts are out of stock or discontinued, equivalent products or upgrades (with possible price difference) will be offered.
- Returned products for replacement must use original packaging. Mispacked / missing items may be refused.

限用物質含有情況標示聲明書

Declaration of the Presence Condition of the Restricted Substances Marking

設備名稱: acer 譯秒聽 AI 翻譯耳機 Equipment name		型號(型式): OHR578 Type designation (Type)				
單元Unit	限用物質及其化學符號 Restricted substances and its chemical symbols					
	鉛 Lead (Pb)	汞 Mercury (Hg)	鎘 Cadmium (Cd)	六價鉻 Hexavalent chromium (Cr6 ⁺)	多溴聯苯 Polybrominated biphenyls (PBB)	多溴二苯醚 Polybrominated diphenyl ethers (PBDE)
外殼 Enclosure	○	○	○	○	○	○
充電線 Charging Cable	○	○	○	○	○	○
電路板 PCBA	○	○	○	○	○	○
按鍵 Button Assembly	○	○	○	○	○	○
<p>備考1. “超出0.1 wt %”及“超出0.01 wt %”係指限用物質之百分比含量超出百分比含量基準值。</p> <p>Note 1: “Exceeding 0.1 wt %” and “exceeding 0.01 wt %” indicate that the percentage content of the restricted substance exceeds the reference percentage value of presence condition.</p> <p>備考2. “○”係指該項限用物質之百分比含量未超出百分比含量基準值。</p> <p>Note 2: “○” indicates that the percentage content of the restricted substance does not exceed the percentage of reference value of presence.</p> <p>備考3. “-”係指該項限用物質為排除項目。</p> <p>Note 3: The “-” indicates that the restricted substance corresponds to the exemption.</p>						

(((CCAM25LP1190T3 (耳機)

(((CCAM25LP1920T1 (Dongle)



R38005
RoHS

acer 譯秒聽 AI 翻譯耳機